

**CALIFORNIA  
UMBRELLA**

**INSTRUCTION MANUAL**

# **CALI SERIES**

**CALI338A/118A/85858A**



Question about your product? Visit [www.californiaumbrella.com](http://www.californiaumbrella.com) and chat with us today.

# COMPONENTS

## Base Box

**1** Frame + Canopy

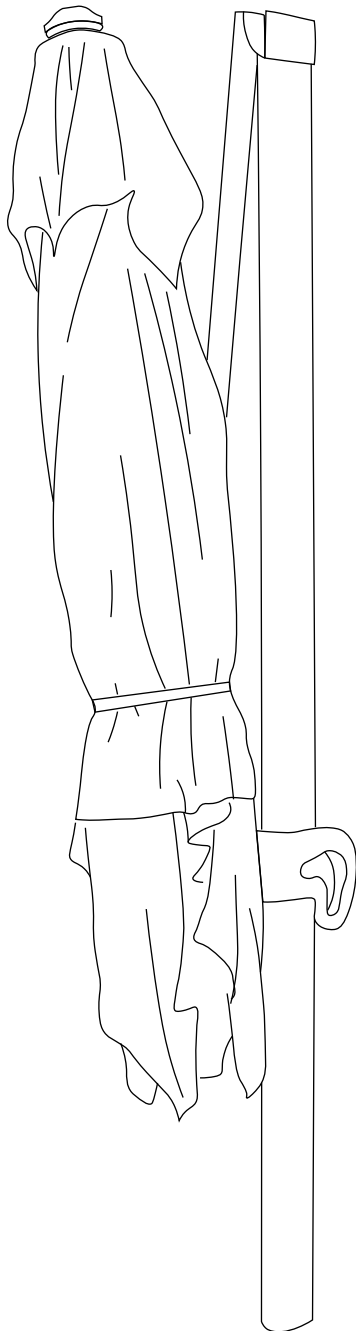

**2** Base Tube

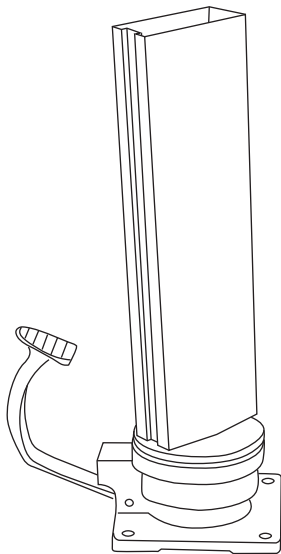

**3** Cross Base  
(Counterweight base sold separately)

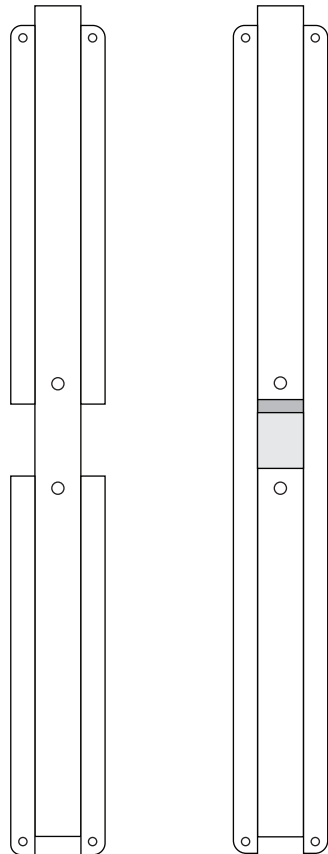

**4** M8-20mm Bolts x4, Washers x4, Hex key x1

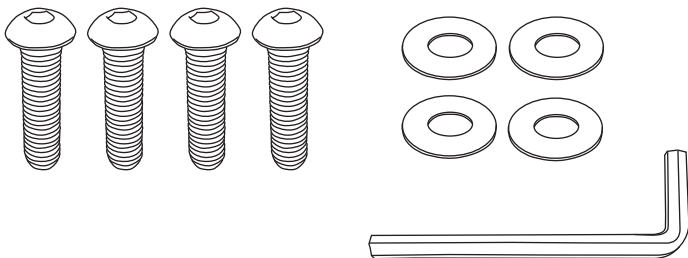

# INSTALLATION

---

---

## WARNING

*RL50 4-section fillable base: compatible with all CALI series sold separately.*

---

### Step 1

Place the top cross plate over the bottom cross plate to form an x. Ensure indentations sit flush.

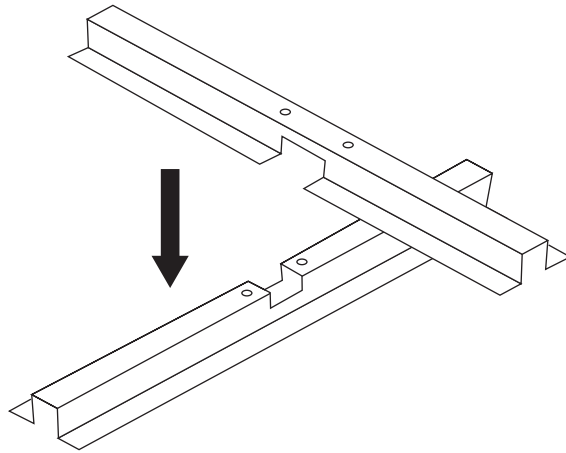

### Step 2

Place the base tube on the cross base and align the four holes on the base tube with the four holes on the cross base. Use the provided bolts and washers to secure in place.

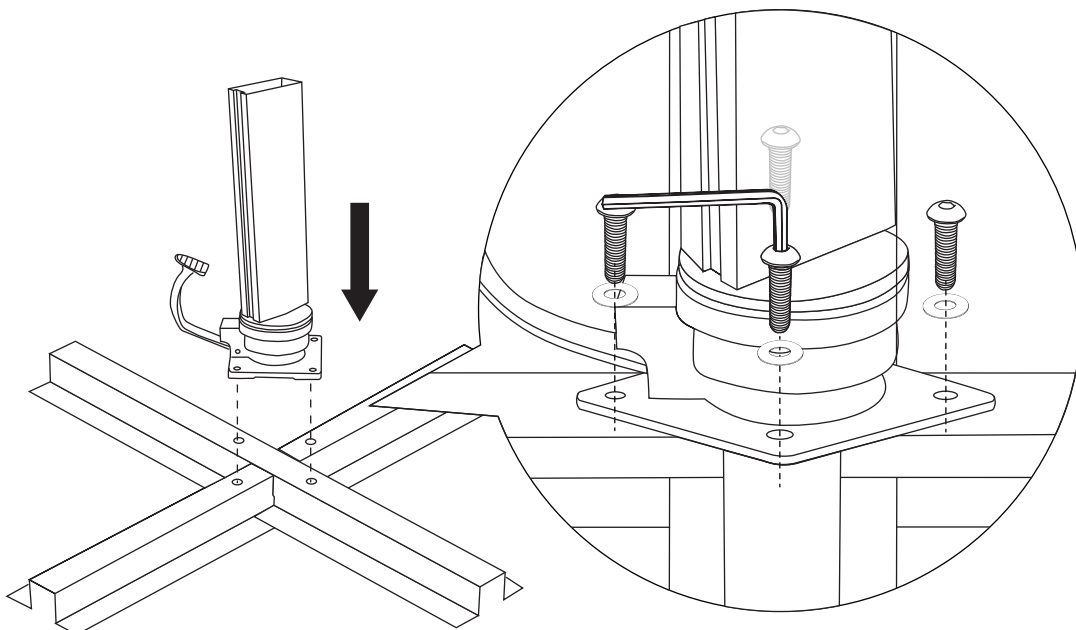

# INSTALLATION

---

## Step 3

With another person, lift the main frame and place over the base tube. The frame and the base tube will click in to place once secure.

Scan to Shop  
Umbrella Bases

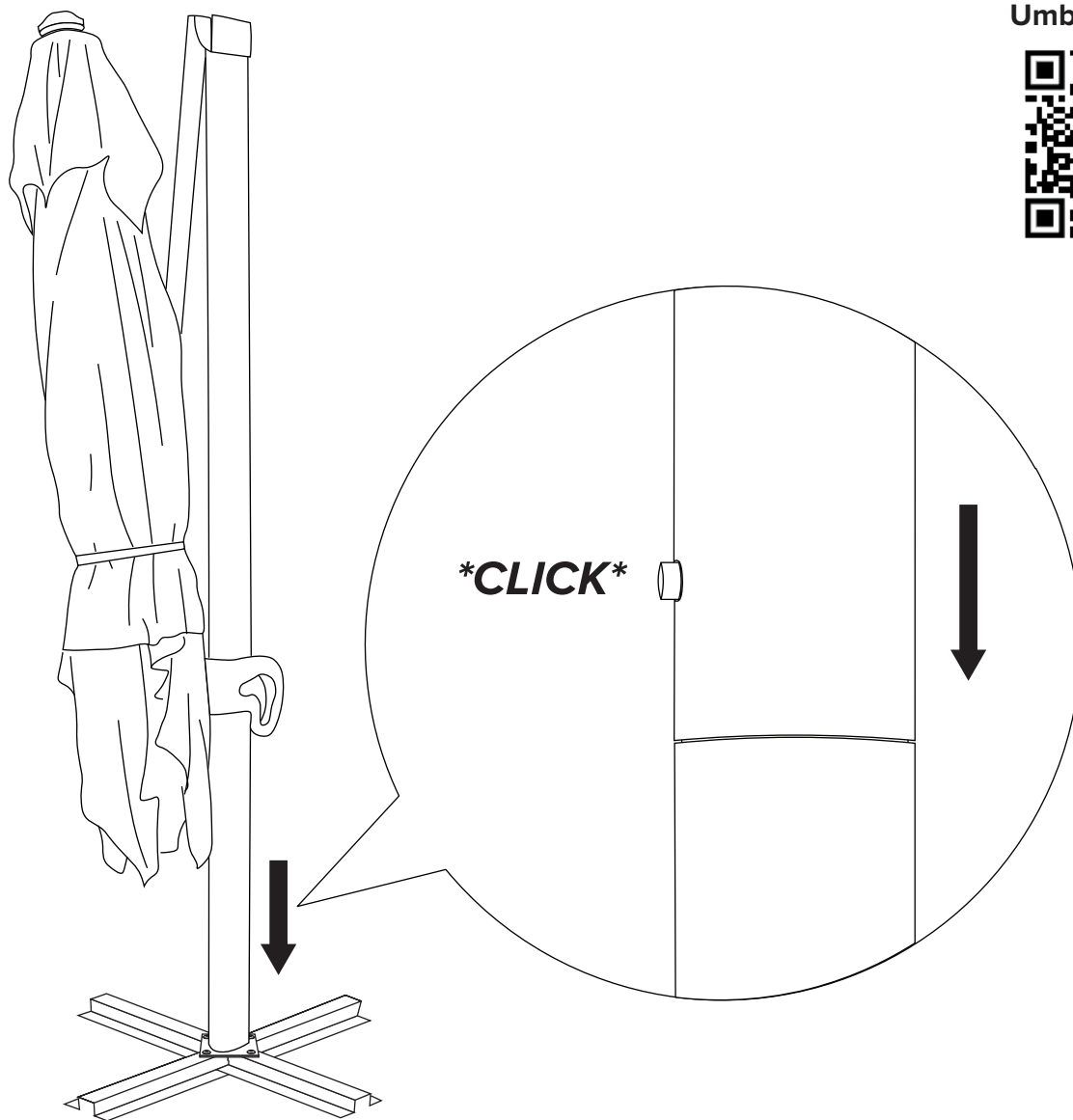

---

## WARNING

*Counterweight is required for this umbrella. Do not open this umbrella until appropriate counterweight is installed.*

---

# OPERATION

## Opening Umbrella

### OPERATION WARNING

*Handle must be placed into the 2nd hole position from the bottom in order to open the canopy. If placed into a higher hole position, the canopy will close on itself after opening.*

### Opening

Squeeze the trigger on the handle to unlock the canopy. Slide the handle upward to the 2nd hole position from the bottom of the frame post. Release trigger to lock into position. Turn the crank handle clockwise until the canopy is fully opened. Canopy will tilt upward. Squeeze the trigger on the handle to release the canopy. Slide the handle upward to straighten the canopy. Release the trigger to lock the position in place.

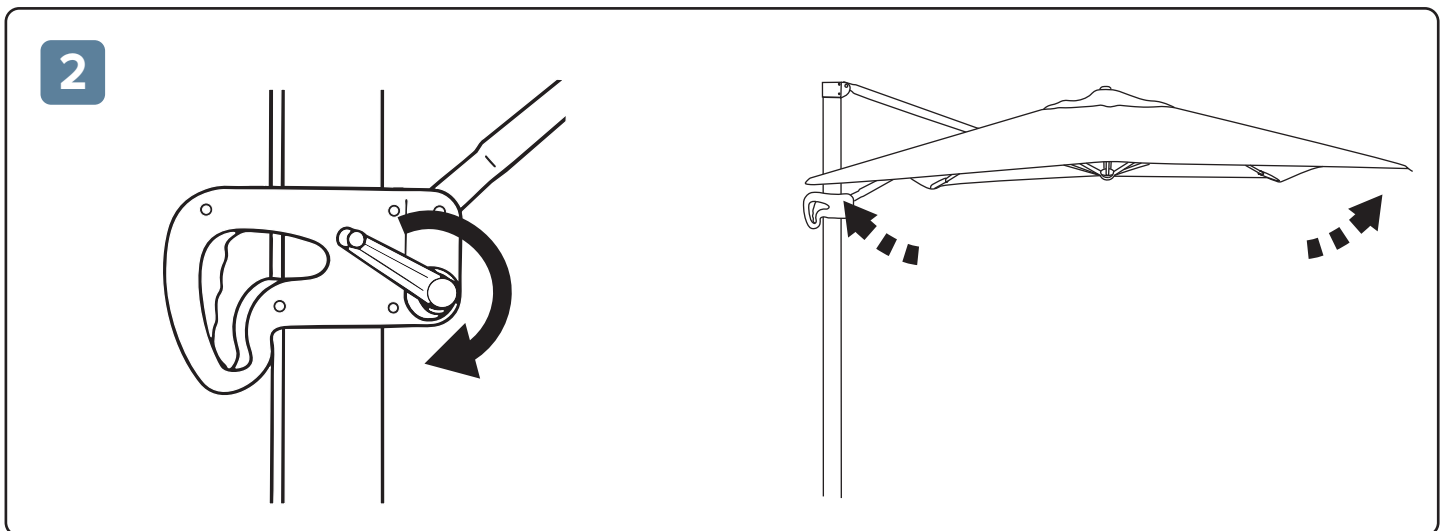
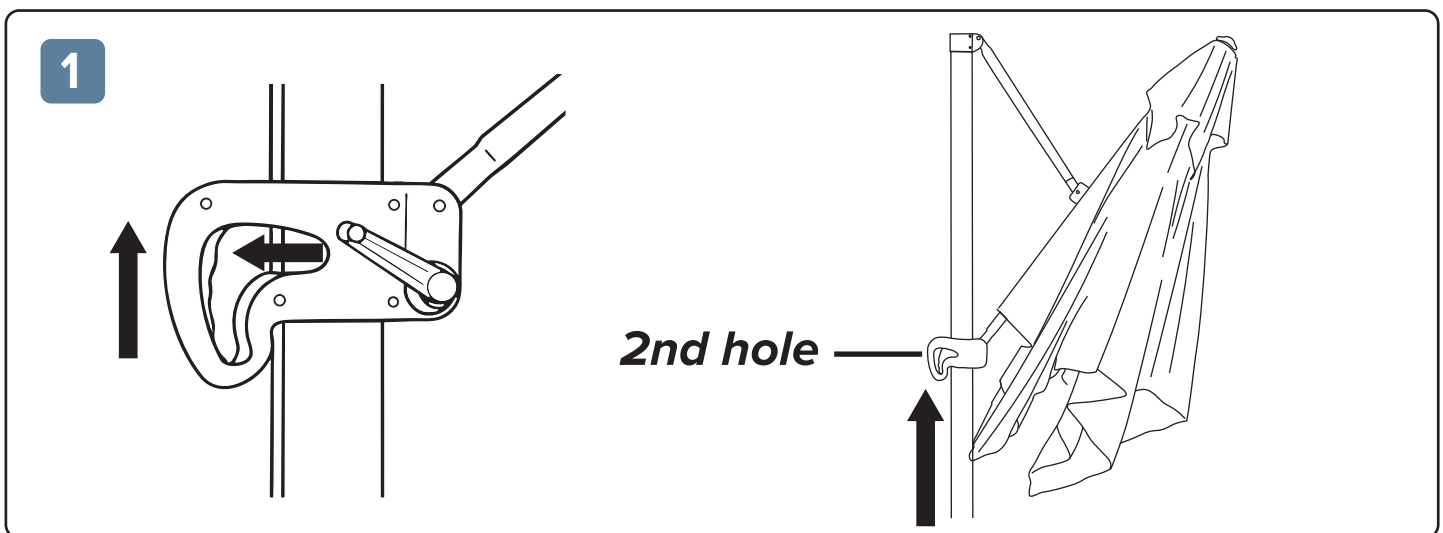

# OPERATION

## Closing Umbrella

### Closing

Return the handle to the 2nd hole position. Turn the crank handle counterclockwise to close the canopy. Press the trigger and slide the handle down to the 1st hole position. The canopy will close completely.

1

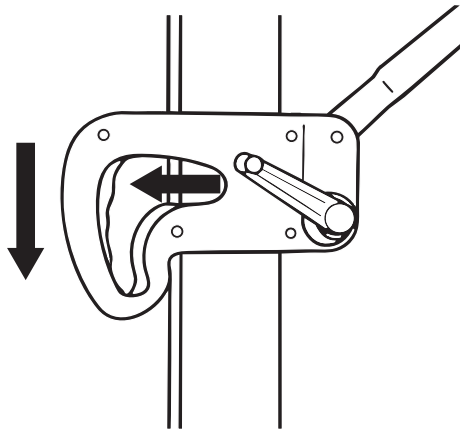

2nd hole

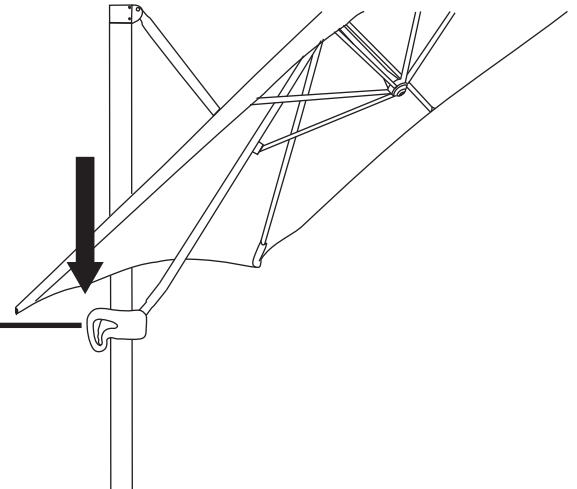

2

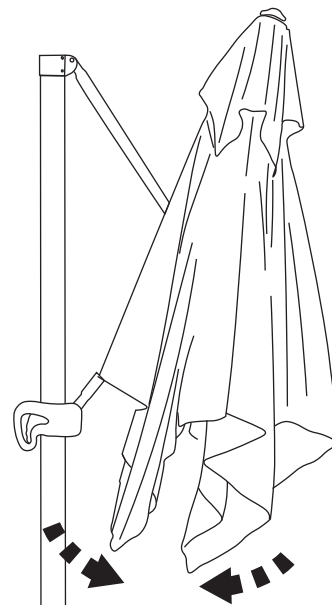
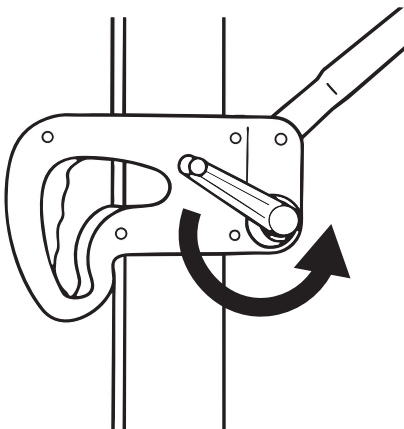

# OPERATION

## Rotating Umbrella

### Rotating

Step on the foot pedal to release the base of the umbrella pole. While pressing the foot pedal down, rotate the frame in 15 degree increments all the way around the axis of the bottom pole. Release the foot pedal to lock the position in place.

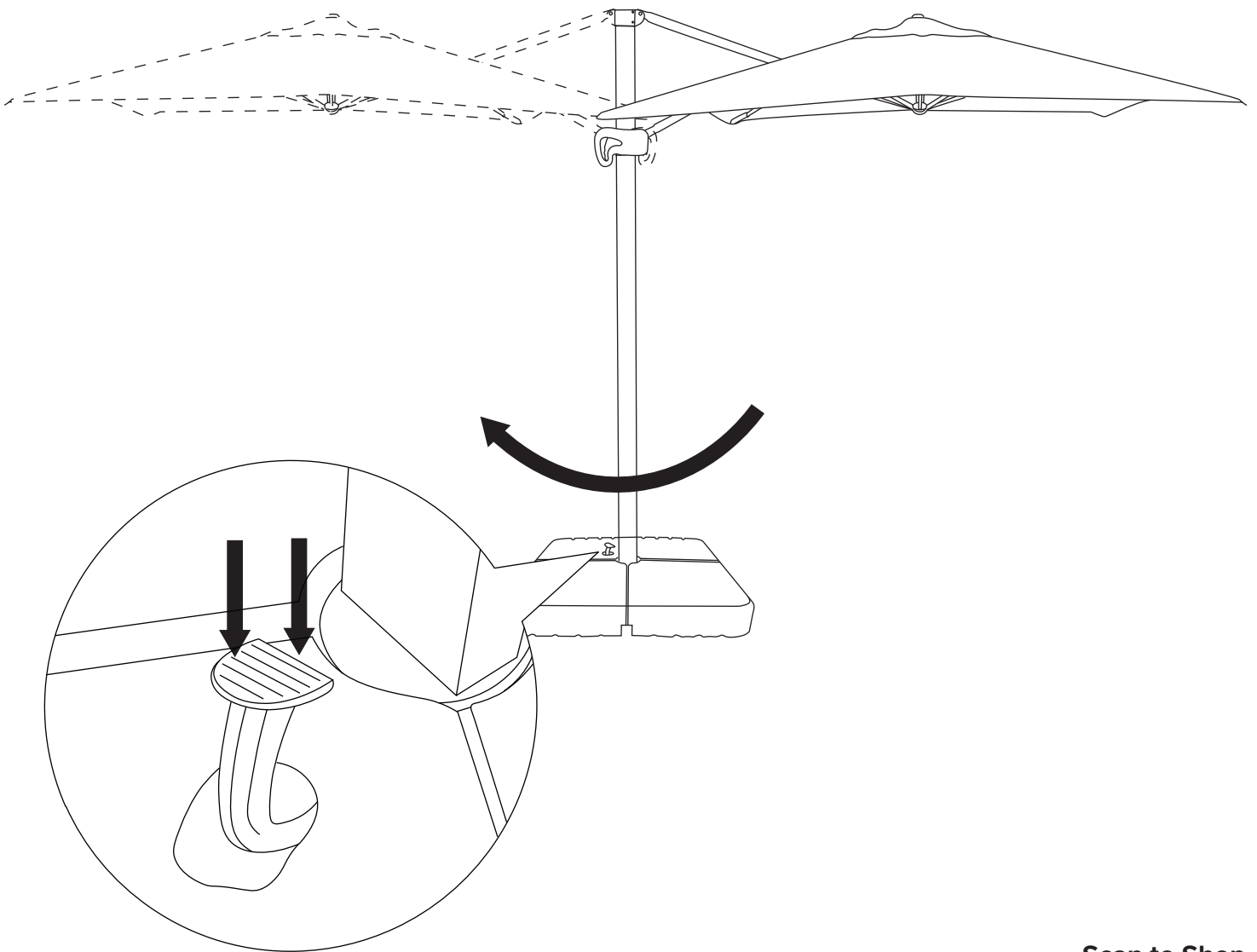

Scan to Shop  
Umbrella Bases



# OPERATION

## Tilting Umbrella

### Tilting

Squeeze the trigger on the handle to release the lock. Slide the handle down the frame to tilt the canopy upward. Release the trigger to lock the position.

#### Tilt Up

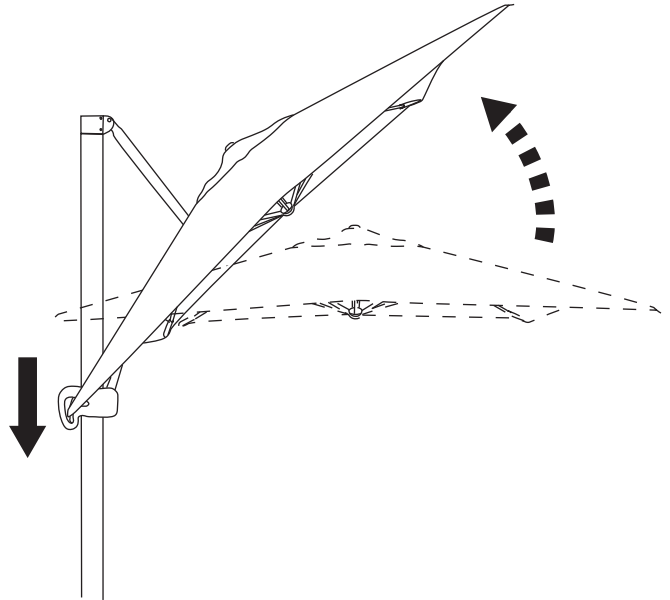
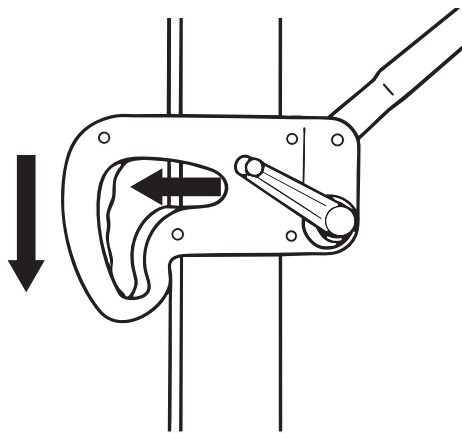

#### Tilt Down

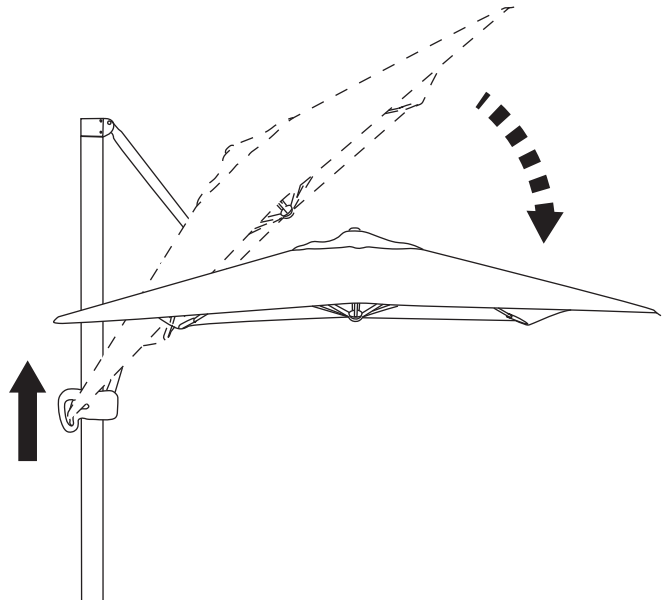
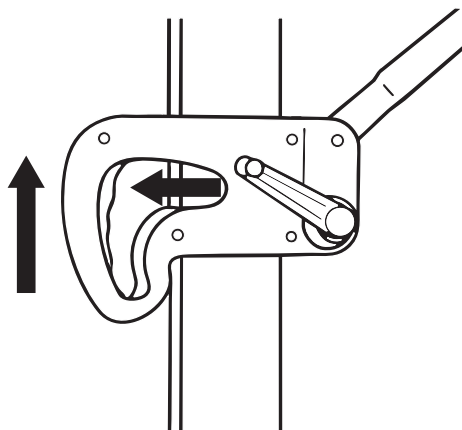



# CARE & MAINTENANCE

---

## Care Tips

- Use an appropriate base or anchoring system to secure the umbrella. Verify the recommended base weight for the item.
- Base and umbrella are meant to lay on a flat surface.
- Always move the umbrella by uninstalling and lifting/placing in desired area.
- Add a fabric defense to your umbrella canopy for an added layer of protection against oil and water-based stains. Visit our website to purchase a bottle of Pacifica Preserve and Protect Fabric Defense.

## General Warnings

- The appropriate base or anchoring system is needed to provide stability for the umbrella. Please verify the recommended base weight for the item.
- May cause damage or injury when used improperly.
- Not meant for commercial use.
- Not meant for use in windy or inclement weather conditions.
- When not in use, cover and store outdoor furniture in a dry and clean area.
- Do not use harsh cleaning products on the surface of your frame or canopy.

## How to Clean

- **Frame**
  - To keep the umbrella frame looking new, wipe the frame with a clean damp cloth and a solution of *mild soap and water*<sup>1</sup>. Dry with a clean dry cloth. While canopy is installed, use a soft bristle brush to regularly remove any loose dirt, leaves, and other debris from fabric.
  - To remove water spots, use a clean cloth or soft bristle brush to scrub the frame with a solution of *white vinegar and water*<sup>2</sup>. Dry with a clean dry cloth.
- **Canopy**
  - While canopy is installed, use a soft bristle brush to regularly remove any loose dirt, leaves, or other debris from the fabric.
  - For spills and stains, spray a mild cleaning solution of *mild soap and water*<sup>1</sup> and scrub with a soft bristle brush or a clean cloth.
  - For more severe cases, purchase the Pacifica: Restore and Renew Fabric Cleaner. Spray the canvas 10 inches way from the surface, use a soft bristle brush to scrub the fabric. Thoroughly remove any residue with clean water.
  - Machine Wash Cold and Air Dry Only.
- **Cleaning Solution**
  - Mild Soap and Water: ¼ cup mild soap : 1 gallon water
  - White Vinegar and Water: 1 cup vinegar : 1 cup water

# WARRANTY

---

## Overview

California Umbrella's limited warranty gives you specific legal rights and you may also have other rights, which vary from state to state.

This limited warranty can also be found at [www.californiaumbrella.com/en/terms-of-sales#warranty](http://www.californiaumbrella.com/en/terms-of-sales#warranty) and in the documentation we provide with the products.

We warrant that during the warranty period, the individual components of the products purchased from the site will be free from defects in materials and workmanship.

We limit the duration and remedies of all implied warranties, including without limitation the warranties of merchantability and fitness for a particular purpose, to the duration of this limited warranty. Our responsibility for defective products is limited to repair, replacement or refund as set forth in this warranty statement. Neither any performance or other conduct, nor any oral or written information, statement or advice provided by us, our agents, or employees will create a warranty, or in any way increase the scope or duration of this limited warranty.

## Frames

- Aluminum frames: 1-year limited warranty
- Fiberglass Ribs: 3-year limited warranty
- If a residential grade umbrella is used for commercial purposes, the warranty is reduced to 90 days.

## Canopies

- All canopies: 1-year limited workmanship warranty
- Olefin fabric: 1-year limited warranty
- Pacifica fabric : 4-year limited warranty
- Sunbrella fabric : 5-year limited warranty
- Sunbrella Awning fabric : 10-year limited warranty

Contact us through our ticketing system on [californiaumbrella.com](http://californiaumbrella.com) for warranty inquiries.