

CALIFORNIA  
UMBRELLA

INSTRUCTION MANUAL  
**BAYSIDE SERIES**  
BA308



Question about your product? Visit [www.californiaumbrella.com](http://www.californiaumbrella.com) and chat with us today.

# COMPONENTS

## Base Box

1 Frame + Canopy

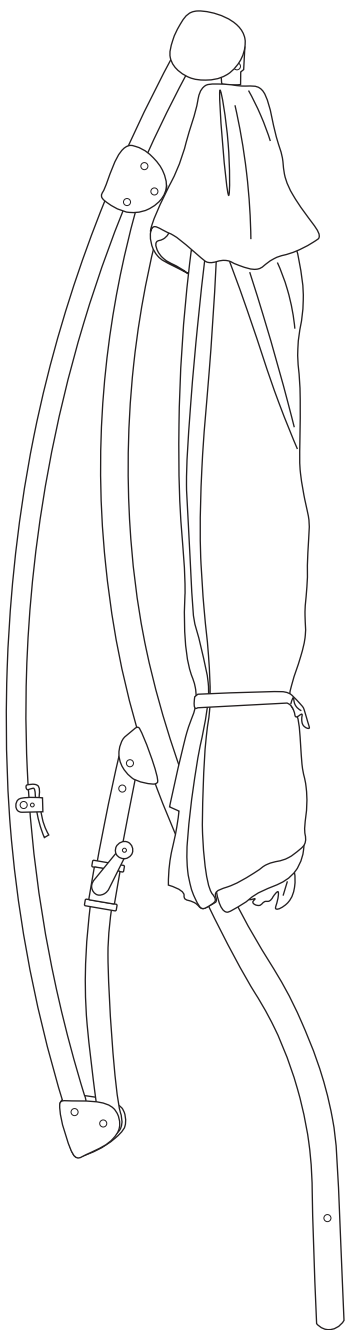

2 Base Tube

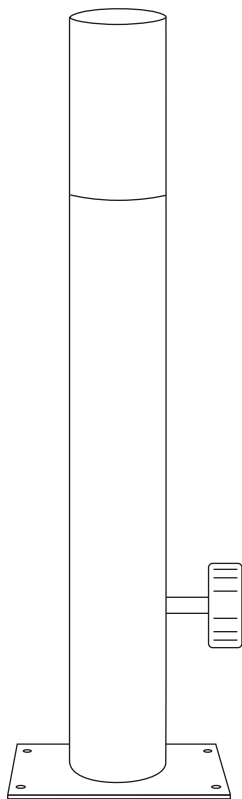

3 Cross Base  
(Counterweight base sold separately)

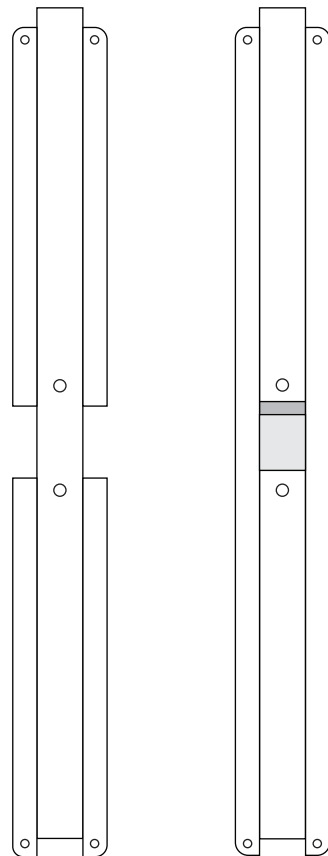

4 M8-20mm Bolts x4, Washers x4, Hex key x1

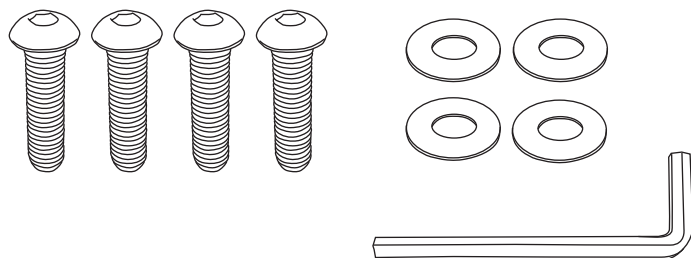

# INSTALLATION

## WARNING

*RL80 2-section fillable base: compatible with BA series sold separately.*

### Step 1

Place the top cross plate over the bottom cross plate to form an x. Ensure indentations sit flush.

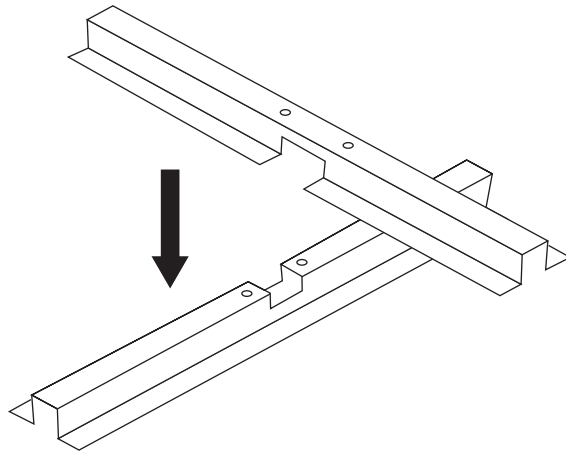

### Step 2

Place the base tube on the cross base and align the four holes on the base tube with the four holes on the cross base. Use the provided bolts and washers to secure in place.

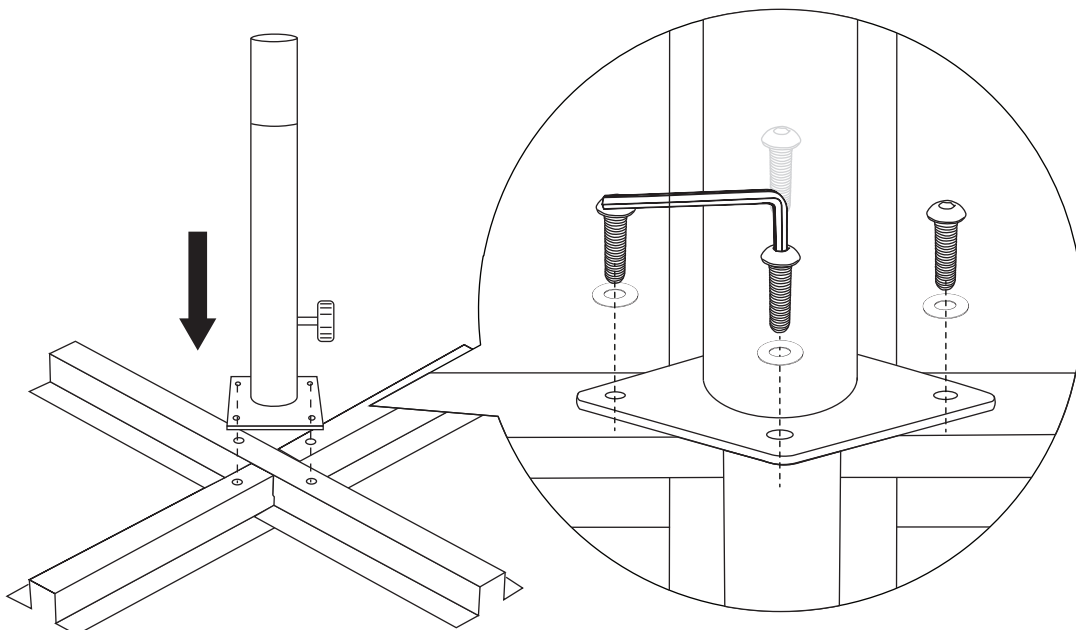

Scan to Shop  
Umbrella Bases



# INSTALLATION

---

## Step 3

Lift the main frame and place it over the base tube. The frame and the base tube will click in to place once secure.

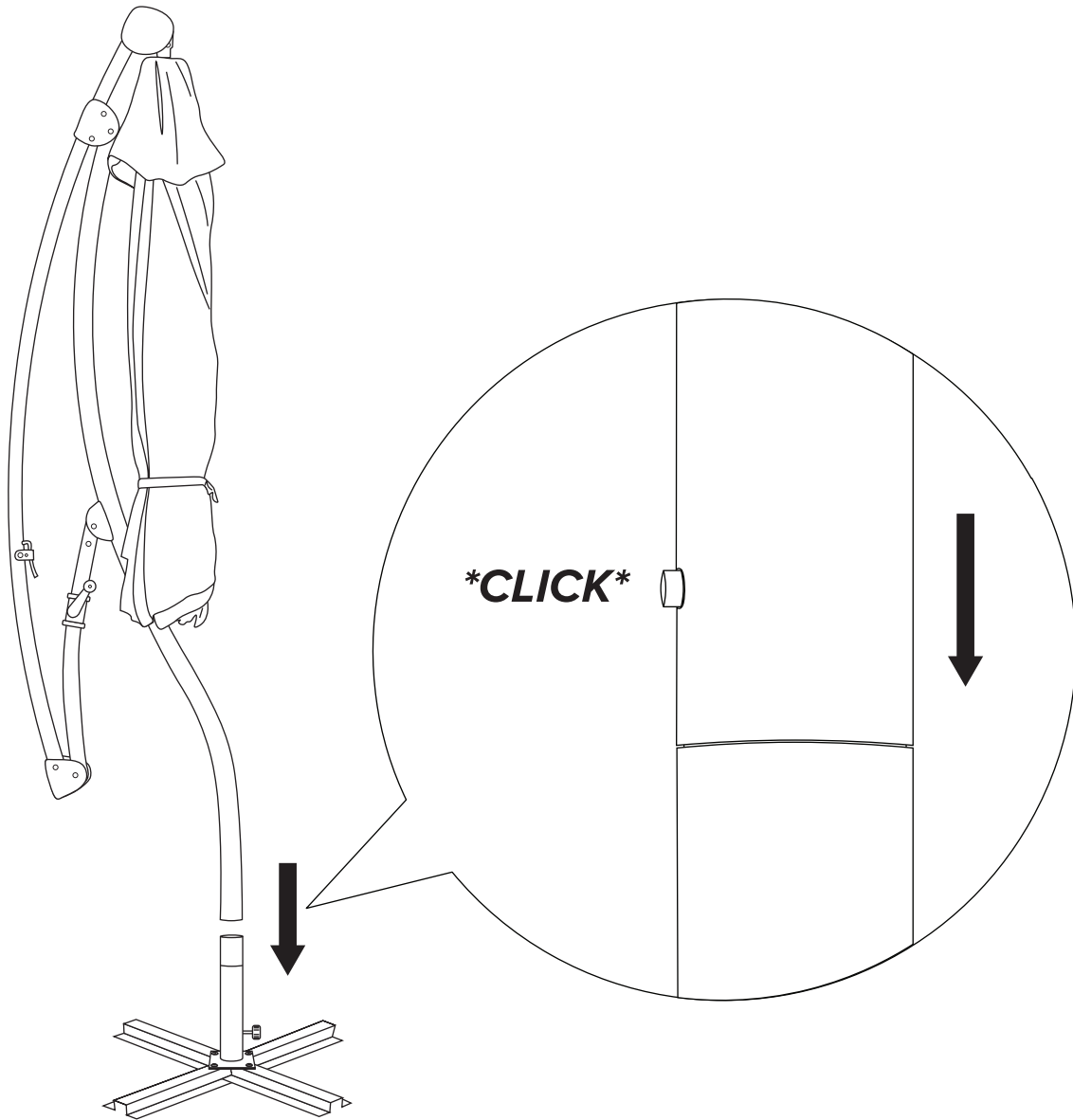

---

### **WARNING**

*Counterweight is required for this umbrella. Do not open this umbrella until appropriate counterweight is installed.*

---

# INSTALLATION

## Step 4

Slowly extend the umbrella arm until the lever clicks into place. You are now ready to open your umbrella.

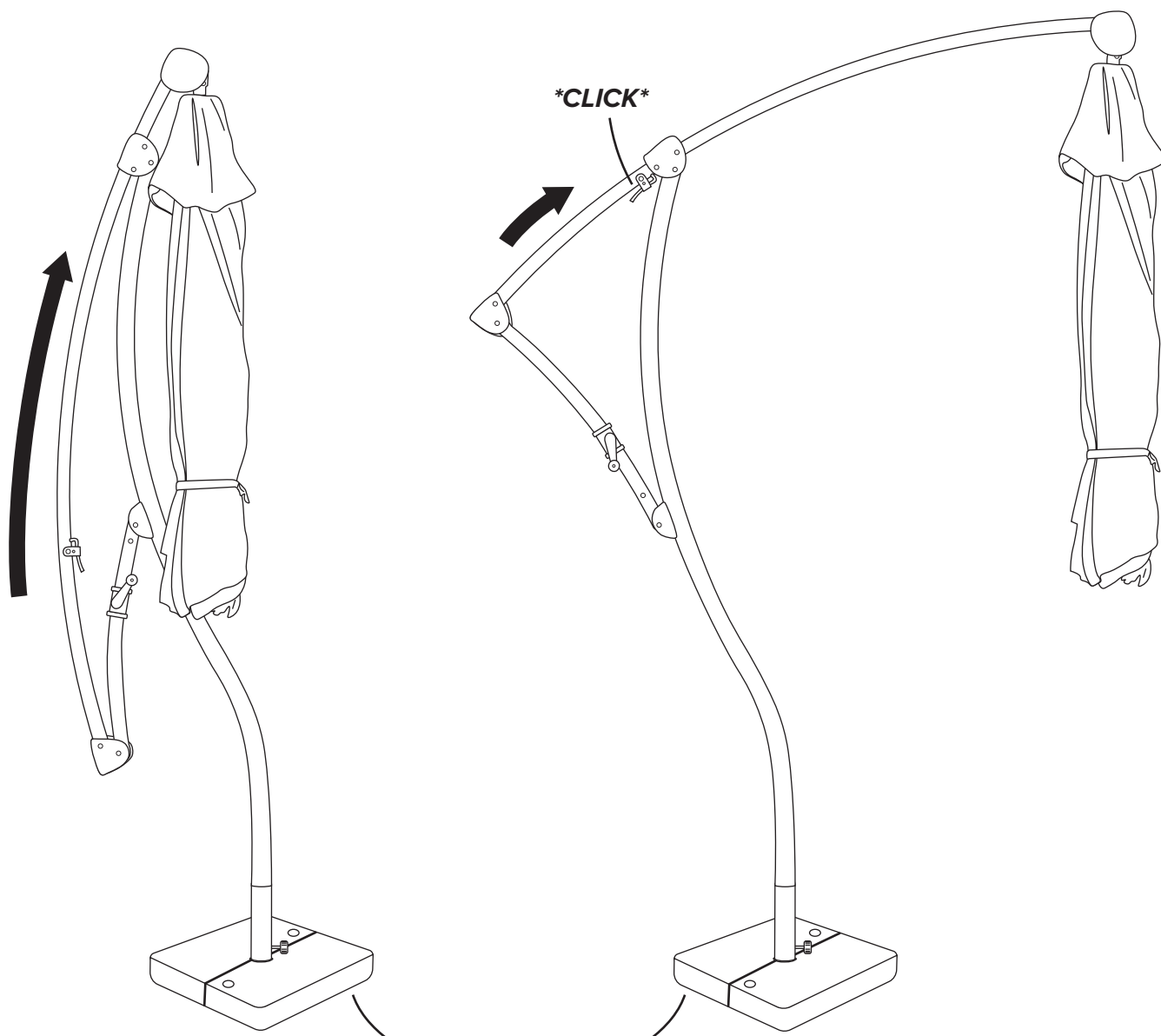

**Recommended Counterweight Base: RL-80**  
Sold separately

Scan to Shop  
Umbrella Bases



# OPERATION

## Opening Umbrella

### Opening

To open the umbrella, turn the crank handle clockwise until the hub in the center connects with the center pole.

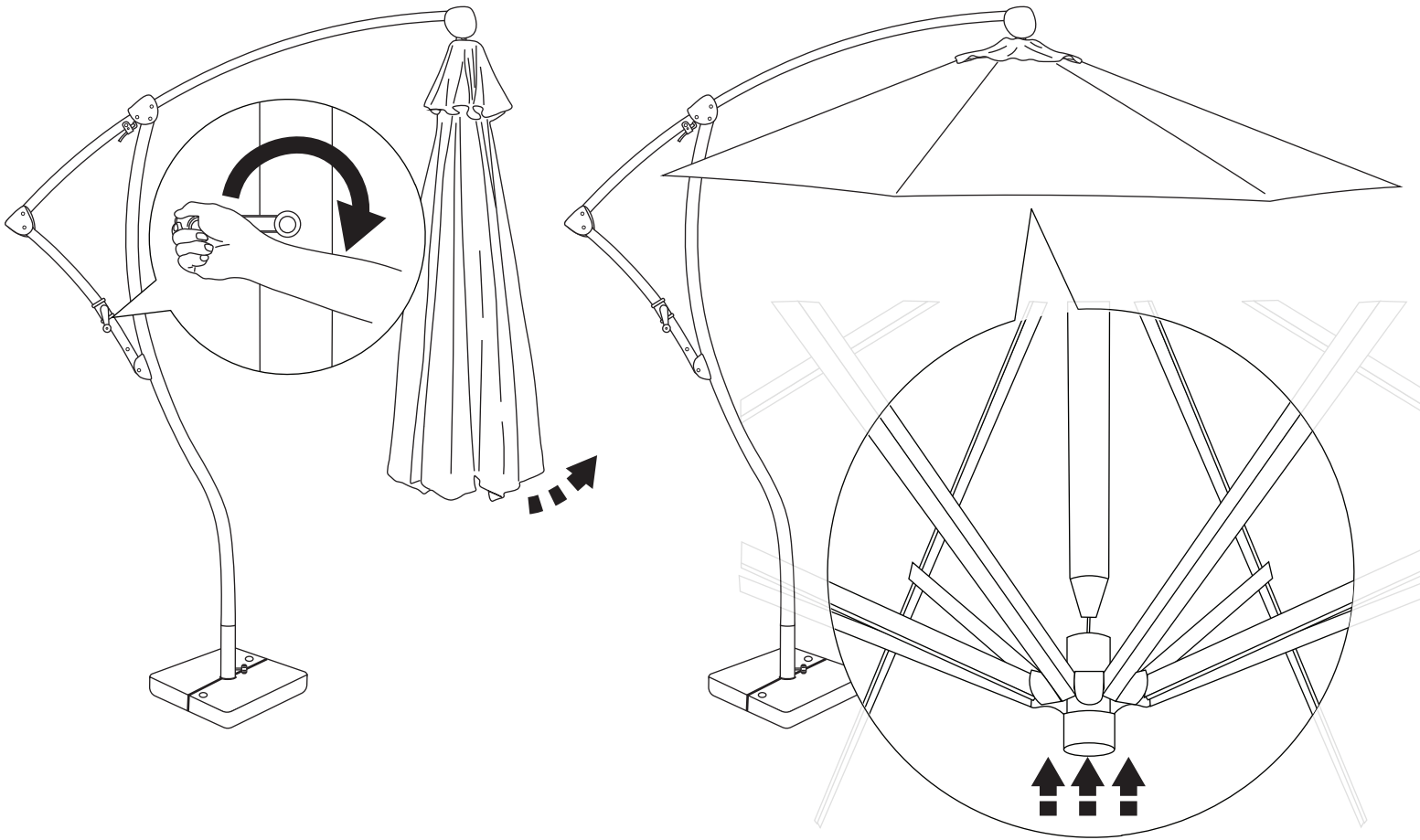

# OPERATION

## Closing Umbrella

### Closing

Turn the crank handle counterclockwise until the canopy is closed. Press the lever to release the lock then slowly guide the arm back down.

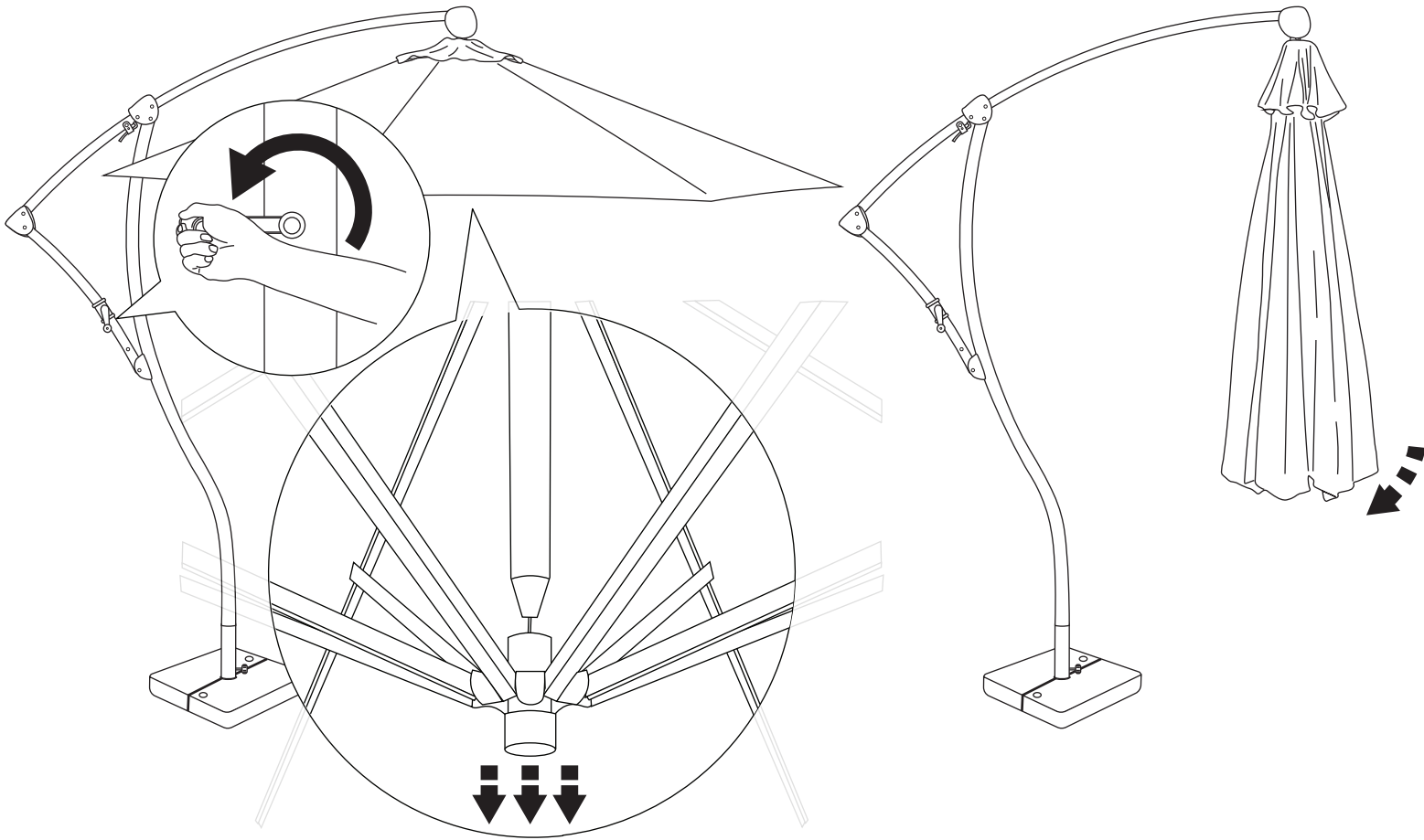

# OPERATION

## Rotating Umbrella

### Rotating

Locate the knob at the bottom of the base tube. Turn the knob counterclockwise to release the base tube rotation. With a sturdy grip on the frame, rotate the frame to the desired position. Turn the knob clockwise to lock the position.

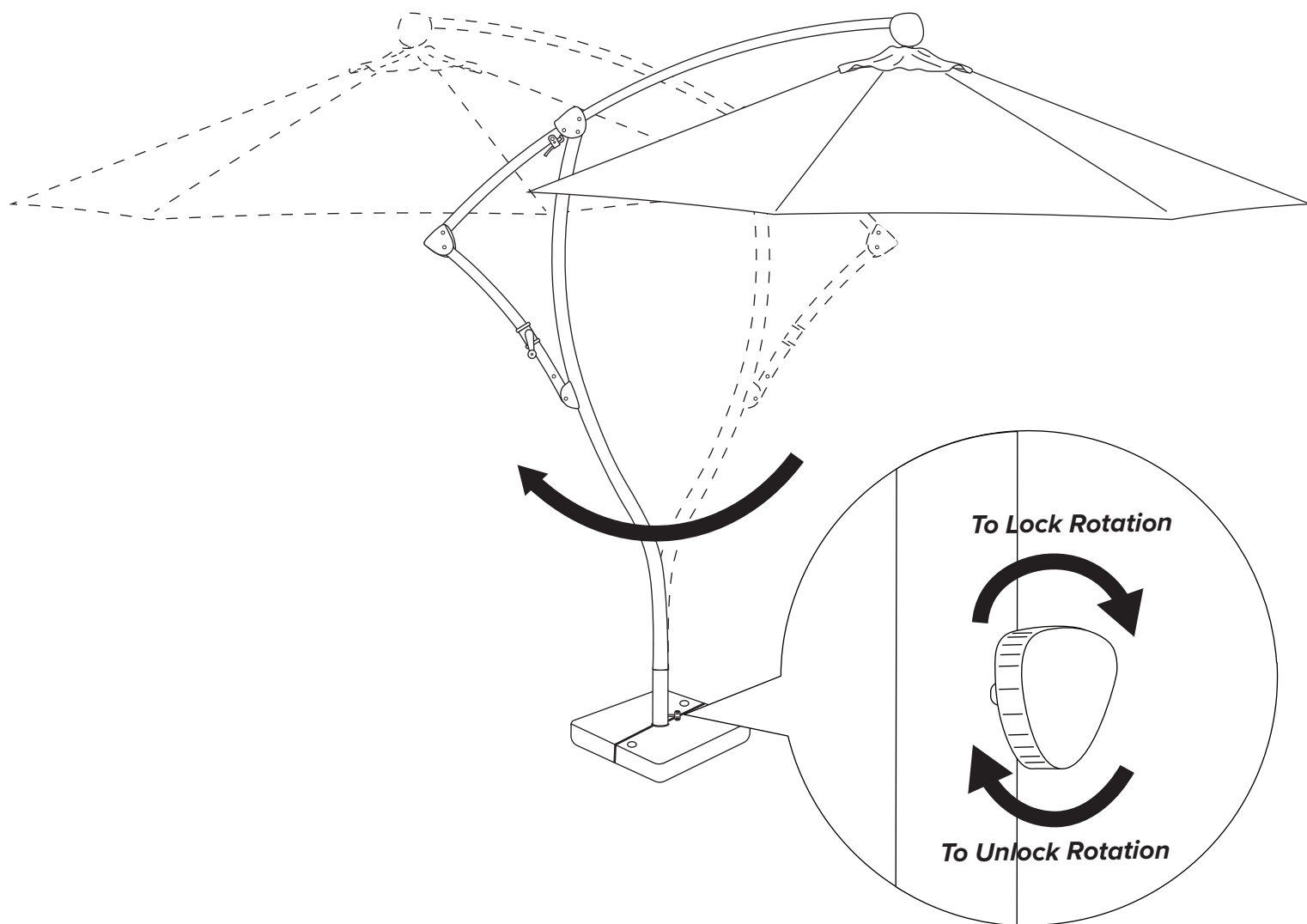

---

### WARNING

*Do not pull on the frame to move the umbrella.*

*Do not lean on the umbrella.*

*Do not force the umbrella to open or close as this can damage your frame.*

*Handle with care.*

---



# CARE & MAINTENANCE

---

## Care Tips

- Use an appropriate base or anchoring system to secure the umbrella. Verify the recommended base weight for the item.
- Base and umbrella are meant to lay on a flat surface.
- Always move the umbrella by uninstalling and lifting/placing in desired area.
- Add a fabric defense to your umbrella canopy for an added layer of protection against oil and water-based stains. Visit our website to purchase a bottle of Pacifica Preserve and Protect Fabric Defense.

## General Warnings

- The appropriate base or anchoring system is needed to provide stability for the umbrella. Please verify the recommended base weight for the item.
- May cause damage or injury when used improperly.
- Not meant for commercial use.
- Not meant for use in windy or inclement weather conditions.
- When not in use, cover and store outdoor furniture in a dry and clean area.
- Do not use harsh cleaning products on the surface of your frame or canopy.

## How to Clean

- **Frame**
  - To keep the umbrella frame looking new, wipe the frame with a clean damp cloth and a solution of *mild soap and water*<sup>1</sup>. Dry with a clean dry cloth. While canopy is installed, use a soft bristle brush to regularly remove any loose dirt, leaves, and other debris from fabric.
  - To remove water spots, use a clean cloth or soft bristle brush to scrub the frame with a solution of *white vinegar and water*<sup>2</sup>. Dry with a clean dry cloth.
- **Canopy**
  - While canopy is installed, use a soft bristle brush to regularly remove any loose dirt, leaves, or other debris from the fabric.
  - For spills and stains, spray a mild cleaning solution of *mild soap and water*<sup>1</sup> and scrub with a soft bristle brush or a clean cloth.
  - For more severe cases, purchase the Pacifica: Restore and Renew Fabric Cleaner. Spray the canvas 10 inches way from the surface, use a soft bristle brush to scrub the fabric. Thoroughly remove any residue with clean water.
  - Machine Wash Cold and Air Dry Only.
- **Cleaning Solution**
  - Mild Soap and Water: ¼ cup mild soap : 1 gallon water
  - White Vinegar and Water: 1 cup vinegar : 1 cup water

# WARRANTY

---

## Overview

California Umbrella's limited warranty gives you specific legal rights and you may also have other rights, which vary from state to state.

This limited warranty can also be found at [www.californiaumbrella.com/en/terms-of-sales#warranty](http://www.californiaumbrella.com/en/terms-of-sales#warranty) and in the documentation we provide with the products.

We warrant that during the warranty period, the individual components of the products purchased from the site will be free from defects in materials and workmanship.

We limit the duration and remedies of all implied warranties, including without limitation the warranties of merchantability and fitness for a particular purpose, to the duration of this limited warranty. Our responsibility for defective products is limited to repair, replacement or refund as set forth in this warranty statement. Neither any performance or other conduct, nor any oral or written information, statement or advice provided by us, our agents, or employees will create a warranty, or in any way increase the scope or duration of this limited warranty.

## Frames

- Aluminum frames: 1-year limited warranty
- Fiberglass Ribs: 3-year limited warranty
- If a residential grade umbrella is used for commercial purposes, the warranty is reduced to 90 days.

## Canopies

- All canopies: 1-year limited workmanship warranty
- Olefin fabric: 1-year limited warranty
- Pacifica fabric : 4-year limited warranty
- Sunbrella fabric : 5-year limited warranty
- Sunbrella Awning fabric : 10-year limited warranty

Contact us through our ticketing system on [californiaumbrella.com](http://californiaumbrella.com) for warranty inquiries.